

Wednesday, August 04, 2010

590 McDeerman Rd, Jacksboro, TN 37757-4206  
Campbell County, TN parcel# 119J A 014.00

## Property Report

### Location

<b>Property Address</b>	590 McDeerman Rd Jacksboro, TN 37757-4206
<b>Subdivision</b>	Little Cove Creek S/D
<b>County</b>	Campbell County, TN

### Current Owner

<b>Name</b>	Kluchurosky Lisa Rohrkemper Mary
<b>Mailing Address</b>	8885 Refugee Rd Sw Pataskala, OH 43062-8626

### Property Summary

<b>Property Type</b>	Residential
<b>Land Use</b>	Household Unit
<b>Improvement Type</b>	Mh4
<b>Square Feet</b>	1680 sf

### General Parcel Information

<b>Parcel/Tax ID</b>	119J A 014.00
<b>Special Int</b>	000
<b>Alternate Parcel ID</b>	
<b>Land Map</b>	119I
<b>District/Ward</b>	03
<b>Census Tract/Block</b>	9,511.00/3

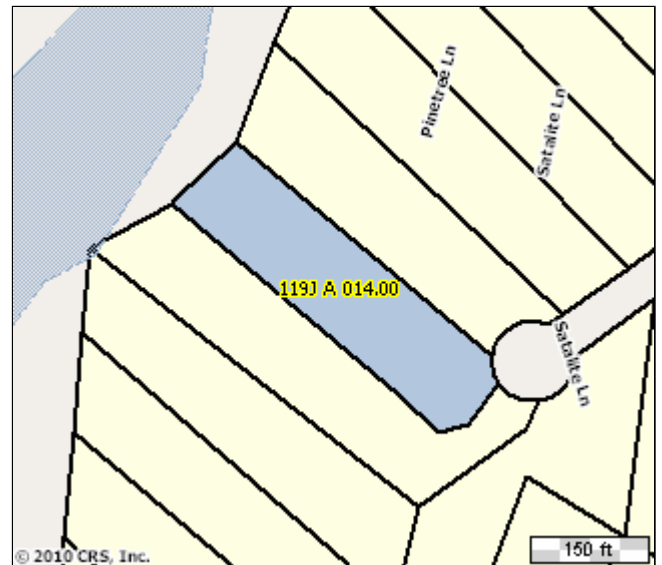

### Sales History through 07/28/2010

Date	Amount	Buyer/Owners	Buyer/Owners 2	Instrument	Quality	Book/Page or Document#
08/24/2009	\$63,800	Kluchurosky Lisa		Warranty Deed		453/848
06/01/2007	\$109,000	Stanford John Etal		Warranty Deed	Completely Qualified	435/337
02/01/1994	\$7,000	Vowell Quentin Etux Betty		Warranty Deed	Completely Qualified	320/743
05/16/1990	\$4,900	Covington Melvin B Etux Donna C		Warranty Deed	Completely Qualified	296/218
02/10/1987		Ayers Haskel Real Est				272/674

### Tax Assessment

Appraisals	Amount	Taxes	Amount	Jurisdiction	Rate
<b>Tax Year</b>	2009	<b>City Taxes</b>	\$0	Campbell	2.000
<b>Appraised Land</b>	\$25,800	<b>County Taxes</b>	\$347.50		
<b>Appraised Improvements</b>	\$43,700	<b>Total Taxes</b>	\$347.50		
<b>Total Tax Appraisal</b>	\$69,500	<b>Exempt Amount</b>			
<b>Total Assessment</b>	\$17,375	<b>Exempt Reason</b>			

### Mortgage History

Date	Loan Amount	Borrower	Lender	Book/Page or Document#
8/24/2009	\$60,000	Stanford John Etal James B Speegle li Etux Cara L	Farm Credit Services Of Mid-America Flca	553/399 9005697

### Property Characteristics: Building

Building #	Type	Condition	Sq Feet	Year Built	Effective Year	BRs	Baths	Rooms	Stories	Units
1	Mh4	Sound	1680	1994	1994				1	
<b>Building Square Feet (Living Space)</b>					<b>Building Square Feet (Other)</b>					
<b>First Story (Base)</b>				1680						
<b>Construction</b>										
<b>Quality</b>	Average		<b>Roof Framing</b>			Flat				
<b>Shape</b>	Square Design		<b>Roof Cover Deck</b>			Corrugated Metal				
<b>Partitions</b>			<b>Cabinet Millwork</b>			None				
<b>Common Wall</b>	0		<b>Floor Finish</b>			Earth				
<b>Foundation</b>	Earth		<b>Interior Finish</b>			None				
<b>Floor System</b>	Earth		<b>Air Conditioning</b>							
<b>Exterior Wall</b>	Unfinished		<b>Heat Type</b>			None				
<b>Structural Framing</b>	None		<b>Bathroom Tile</b>			None				
<b>Fireplace</b>			<b>Plumbing Fixtures</b>							
<b>Other</b>										
<b>Occupancy</b>	Occupied		<b>Building Data Source</b>			Owner				

### Property Characteristics: Extra Features

Feature	Size or Description	Year Built	Condition
Cooling		1994	Average
Mh Opu	8X56	1994	Average

Dgu	20X26	1998	Average
Utl Bld	10X12	1998	Fair
Mh Opf	8X56	1994	Fair
Utl Bld	8X12	1998	Fair
Skirt	30X56	1994	Average
Utl Bld	8X10	1994	Fair

#### Property Characteristics: Lot

<b>Land Use</b>	Household Unit	<b>Lot Dimensions</b>	
<b>Block/Lot</b>	/2&	<b>Lot Square Feet</b>	
<b>Latitude/Longitude</b>	36.298804°/-84.182966°	<b>Acreage</b>	1.15

#### Property Characteristics: Utilities/Area

<b>Gas Source</b>	None	<b>Road Type</b>	Paved
<b>Electric Source</b>	Public	<b>Topography</b>	Rolling
<b>Water Source</b>	Public	<b>District Trend</b>	Static
<b>Sewer Source</b>	Individual	<b>Special School District 1</b>	000
<b>Zoning Code</b>		<b>Special School District 2</b>	000
<b>Owner Type</b>			

#### Legal Description

<b>Subdivision</b>	Little Cove Creek S/D	<b>Plat Book/Page</b>	1/607
<b>Block/Lot</b>	/2&	<b>Description</b>	120D A 120D 012.00 000
<b>District/Ward</b>	03		

Wednesday, August 04, 2010

590 McDeerman Rd, Jacksboro, TN 37757-4206  
Campbell County, TN parcel# 119J A 014.00

COPYRIGHT © 2010 COURTHOUSE RETRIEVAL SYSTEM. ALL RIGHTS RESERVED.  
Information Deemed Reliable But Not Guaranteed.  
Contact Us at (800) 374-7488 ext 3 for Help.